



# 101 SERIES

## ISO-A CARBON STEEL

Manufactured according to ISO 7241-A  
(1/2" and 3/4" conform to ISO 5675)

### TECHNICAL FEATURES

<b>Operating pressure:</b>	Up to 350 Bar
<b>Materials:</b>	Body: Carbon Steel EN 10277-3 O-rings: NBR / VITON / EPDM Back-up-ring: PTFE Springs: EN 10270-1/SH Balls: AISI 1010/1015
<b>Available Threads:</b>	BSP / NPTF / ISO 11926 (J1926)
<b>Closing System:</b>	Poppet Valve or Ball / C.U.R.P.*
<b>Connection / Disconnection</b>	Sleeve Retraction
<b>Connection Under Pressure:</b>	Not Allowed / Only C.U.R.P. version

**Available Size:** 1/4" a 2"

#### Working Temperature (O-rings)

NBR	Viton	EPDM
+100°C	+200°C	+150°C
-30°C	-10°C	-40°C

#### Sectors: Industrial / Agricultural



**Applications:** Designed for Hydraulic Oil (Group II-2014/68/EU)

**Interchange:** FASTER ANV - AEROQUIP FD56  
PARKER 6600 - SNAP-TITE 61

*\*Other upon request.*

### MODEL STRUCTURE

Example:

**101.11112 BC**

Series	Material	Part	Closing	O-rings	Size (S)	Thread
<b>101.</b>	1 Carbon St. 2 AISI 316 3 AISI 303 4 Brass	1 Male 2 Female	0 Without 1 Poppet 2 Ball 3 C.U.R.P.*	0 Without 1 NBR 2 VITON 3 EPDM	1 6 1/4" 2 10 3/8" 3 13 1/2" 4 20 3/4" 5 25 1" 6 32 1 1/4" 7 40 1 1/2" 8 50 2"	2 letters (see Table of Threads page 999-1)

\* (S) 13 - 1/2" available only.

**101-1**

INTEVA reserves the right to make modifications to its products without prior notice. Any external or internal alterations to our products will automatically void the warranty.





# 101 SERIES

## ISO-A CARBON STEEL

(S) 6 - 1/4"

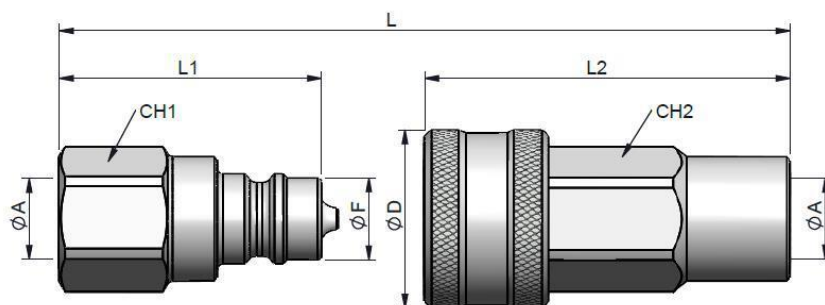

STANDARD MALE MODELS

(S)	ØA	REF.		CH1	L1	ØF	L
6	1/4" BSP	101.11111AB		350	19	38	12
	1/4" NPTF	101.11111BB					
							76

STANDARD FEMALE MODELS

(S)	ØA	REF.		CH2	L2	ØD	L
6	1/4" BSP	101.12111AB		350	19	53	26
	1/4" NPTF	101.12111BB					
							76

(S) 10 - 3/8"

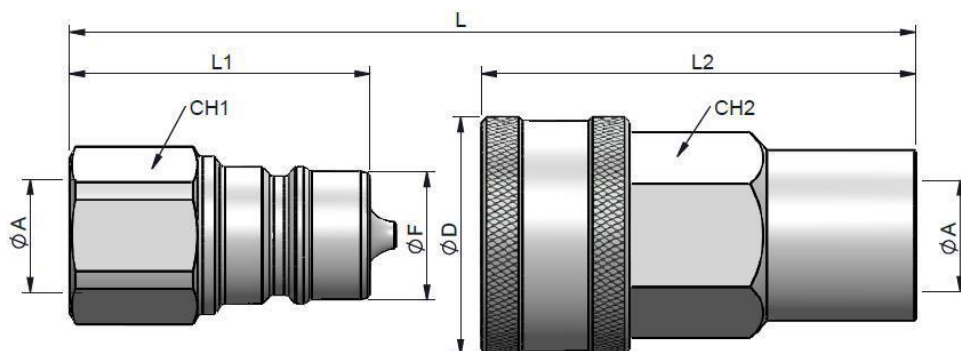

STANDARD MALE MODELS

(S)	ØA	REF.		CH1	L1	ØF	L
10	3/8" BSP	101.11112AC		300	22	40.5	17
	3/8" NPTF	101.11112BC					
	3/8" BSPT	101.11112DC					
	9/16" 18h UNF (ORB)	101.11112GC					
							81

STANDARD FEMALE MODELS

(S)	ØA	REF.		CH2	L2	ØD	L
10	3/8" BSP	101.12112AC		300	24	58.50	32
	3/8" NPTF	101.12112BC					
	3/8" BSPT	101.12112DC					
	9/16" 18h UNF (ORB)	101.12112GC					
							81

L= Total length when Male and Female are connected.



# 101 SERIES

## ISO-A CARBON STEEL

(S) 13 - 1/2"

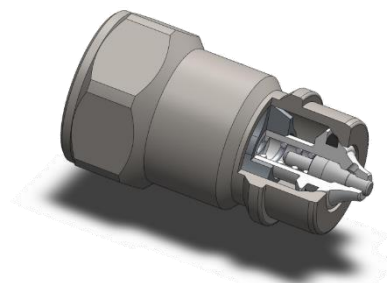
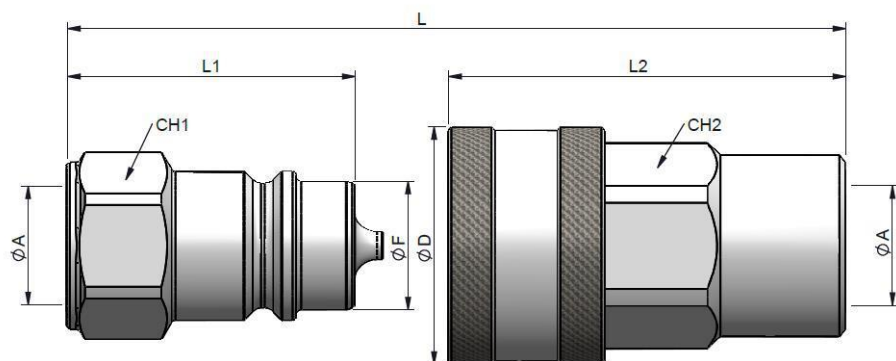

C.U.R.P. System available  
Allowed connection under  
residual pressure.

STANDARD MALE MODELS

(S)	ØA	REF.		CH1	L1	ØF	L
13	1/2" BSP	101.11113AD		27/30	46	20.50	87.50
	1/2" NPTF	101.11113BD					
	M22X1.5	101.11113NG		27/30			
	3/4"-16h UNF (ORB)	101.11113GF		27/30			
	7/8"-14h UNF (ORB)	101.11113GH		27/30			

STANDARD FEMALE MODELS

(S)	ØA	REF.		CH2	L2	ØD	L
13	1/2" BSP	101.12113AD		30	63.50	38	87.50
	1/2" NPTF	101.12113BD					
	M22X1.5	101.12113NG					
	3/4"-16h UNF (ORB)	101.12113GF					
	7/8"-14h UNF (ORB)	101.12113GH					

(S) 20 - 3/4"

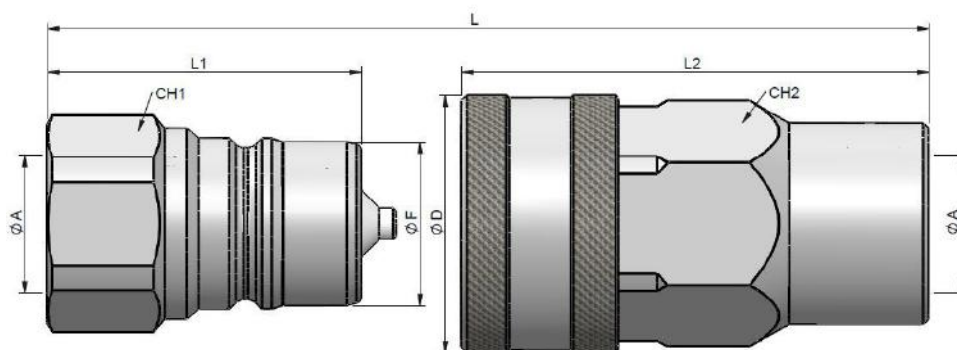

STANDARD MALE MODELS

(S)	ØA	REF.		CH1	L1	ØF	L
20	3/4" BSP	101.11114AE		36	56	29	112
	3/4" NPTF	101.11114BE					
	1 1/16"-12h UN (ORB)	101.11114GK					

STANDARD FEMALE MODELS

(S)	ØA	REF.		CH2	L2	ØD	L
20	3/4" BSP	101.12114AE		38	83.5	46	112
	3/4" NPTF	101.12114BE					
	1 1/16"-12h UN (ORB)	101.12114GK					

L= Total length when Male and Female are connected.

101-3

INTEVA reserves the right to make modifications to its products without prior notice. Any external or internal alterations to our products will automatically void the warranty.



v9



# 101 SERIES

## ISO-A CARBON STEEL

(S) 25 - 1"

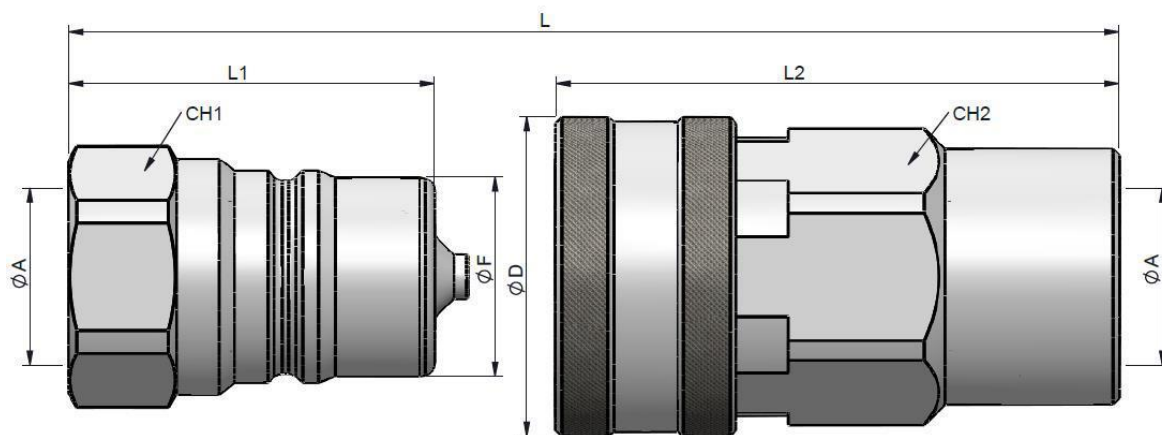

STANDARD MALE MODELS

(S)	ØA	REF.		CH1	L1	ØF	L
25	1" BSP	101.11115AF		41	63	34	126
	1" NPTF	101.11115BF					
	1 5/16"-12h UN (ORB)	101.11115GO					

STANDARD FEMALE MODELS

(S)	ØA	REF.		CH2	L2	ØD	L
25	1" BSP	101.12115AF		46	97	55	126
	1" NPTF	101.12115BF					
	1 5/16"-12h UN (ORB)	101.12115GO					

(S) 32 - 1 1/4"

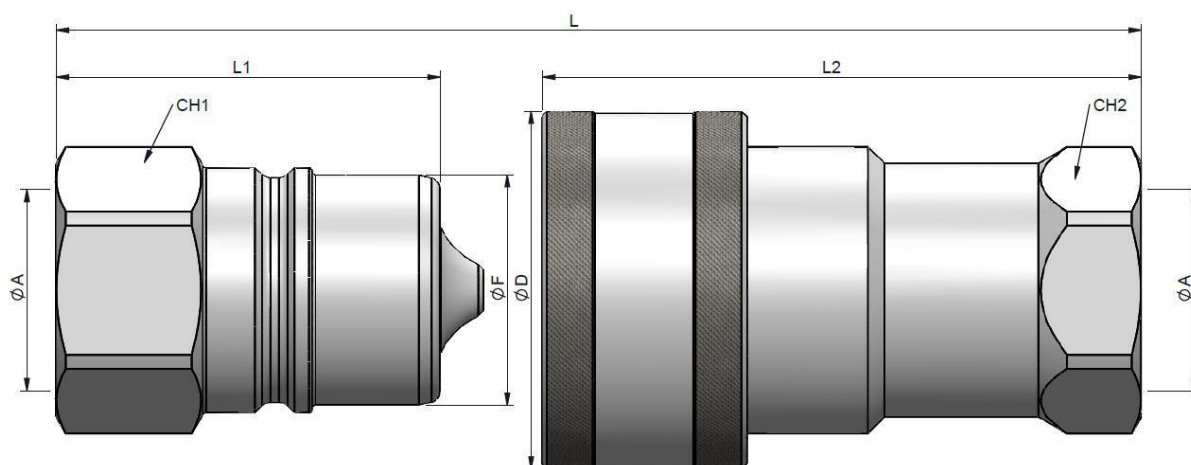

STANDARD MALE MODELS

(S)	ØA	REF.		CH1	L1	ØF	L
32	1 1/4" BSP	101.11116AG		50	75	45	150
	1 1/4" NPTF	101.11116BG					

STANDARD FEMALE MODELS

(S)	ØA	REF.		CH1	L1	ØF	L
32	1 1/4" BSP	101.12116AG		50	117	70	150
	1 1/4" NPTF	101.12116BG					

L= Total length when Male and Female are connected.



# 101 SERIES

## ISO-A CARBON STEEL

(S) 40 - 1 1/2"

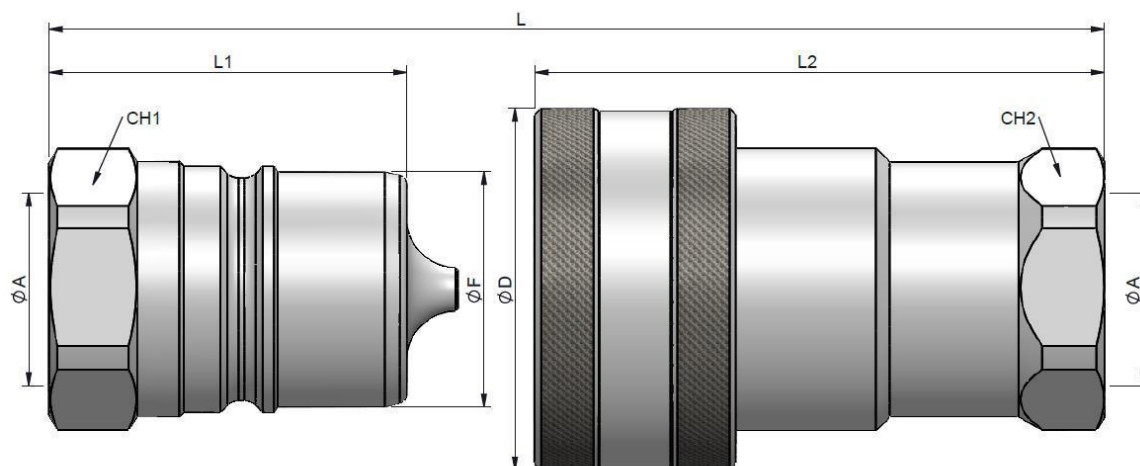

(S)	ØA	REF.		CH1	L1	ØF	L	(S)	ØA	REF.		CH2	L2	ØD	L
40	1 1/2" BSP	101.11117AH	200	60	83.5	55	167	40	1 1/2" BSP	101.12117AH	200	60	133	84.50	167
	1 1/2" NPTF	101.11117BH							1 1/2" NPTF	101.12117BH					

(S) 50 - 2"

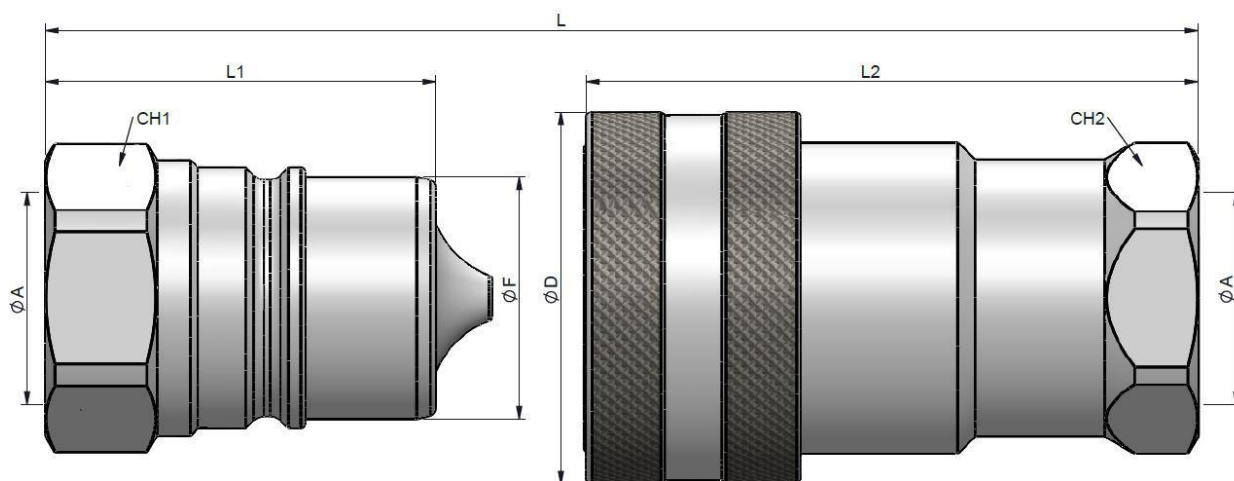

STANDARD MALE MODELS

(S)	ØA	REF.		CH1	L1	ØF	L
50	2" BSP	101.11118AI	130	75	105	65	210
	2" NPTF	101.11118BI					

STANDARD FEMALE MODELS

(S)	ØA	REF.		CH2	L2	ØD	L
50	2" BSP	101.12118AI	130	75	165	100	210
	2" NPTF	101.12118BI					

L= Total length when Male and Female are connected.

101-5

INTEVA reserves the right to make modifications to its products without prior notice. Any external or internal alterations to our products will automatically void the warranty.



v9





# 101 SERIES

## ISO-A CARBON STEEL

### TECHNICAL DATA

(S)	Rated Flow	Min Burst Pressure (Bar)			Operating pressure
		Male	Female	Coupled	
6	15 l/min	1650	1800	1400	350
10	35 l/min	1250	1350	1200	300
13	45 l/min	1200	1300	1200	300
20	74 l/min	1030	1200	1000	250
25	100 l/min	950	980	920	230
32	118 l/min	800	950	920	230
40	410 l/min	750	850	800	200
50	860 l/min	620	650	520	130

Test performed according to ISO 18869

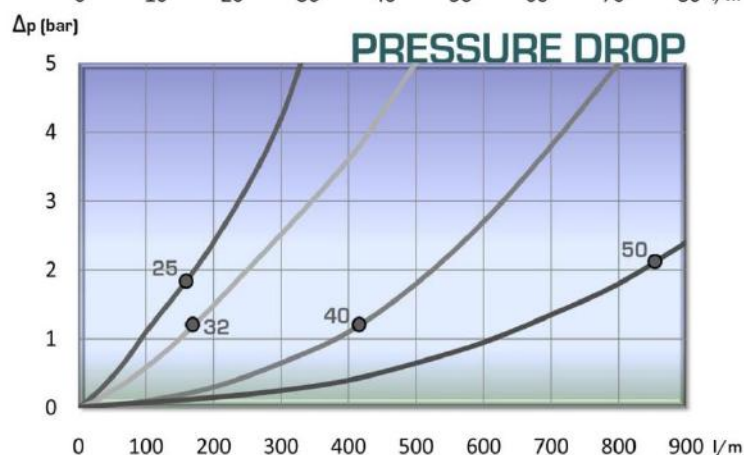
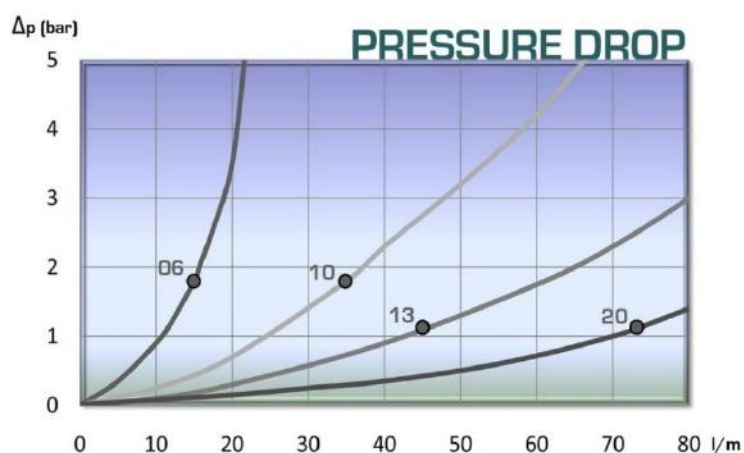

101-6

INTEVA reserves the right to make modifications to its products without prior notice. Any external or internal alterations to our products will automatically void the warranty.



v9



# 101 SERIES

## ISO-A

STAINLESS STEEL (AISI 316)  
BRASS

Manufactured according to ISO 7241-A  
(Measure 1/2" according to ISO 5675 requirements)

### TECHNICAL FEATURES

<b>Operating pressure:</b>	Up to 280 Bar	
<b>Materials:</b>	Body:	AISI 303 / AISI316 / BRASS
	O-rings:	NBR / VITON / EPDM
	Back-up-ring:	PTFE
	Springs:	EN 10270-1/SH
	Balls:	AISI 1010/1015/AISI SS 316
<b>Available Threads:</b>	BSP / NPTF / ISO 11926 (J1926)	
<b>Closing System:</b>	Poppet Valve or Ball	
<b>Connection / Disconnection</b>	Sleeve Retraction	
<b>Connection Under Pressure:</b>	Not Allowed	

**Available Size:** 1/4" a 2"

#### Working Temperature (O-rings)

NBR	Viton	EPDM
+100°C	+200°C	+150°C
-30°C	-10°C	-40°C

#### Sectors: Industrial / Agricultural



**Applications:** Designed for Hydraulic Oil (Group II-2014/68/EU)

**Interchange:** FASTER ANV - AEROQUIP FD56  
PARKER 6600 - SNAP-TITE 61

*\*Other upon request.*

### MODEL STRUCTURE

Example:

**101.21123 AD**

Series	Material	Part	Closing	O-rings	Size (S)	Thread
<b>101.</b>	1 Carbon St.	1 Male	0 Without	0 Without	1 6	1/4"
	2 AISI 316	2 Female	1 Poppet	1 NBR	2 10	3/8"
	3 AISI 303		2 Ball	2 VITON	3 13	1/2"
	4 Brass			3 EPDM	4 20	3/4"
					5 25	1"
					6 32	1 1/4"
					7 40	1 1/2"
					8 50	2"



# 101 SERIES

## ISO-A STAINLESS STEEL (AISI 316)

(S) 6 - 1/4"

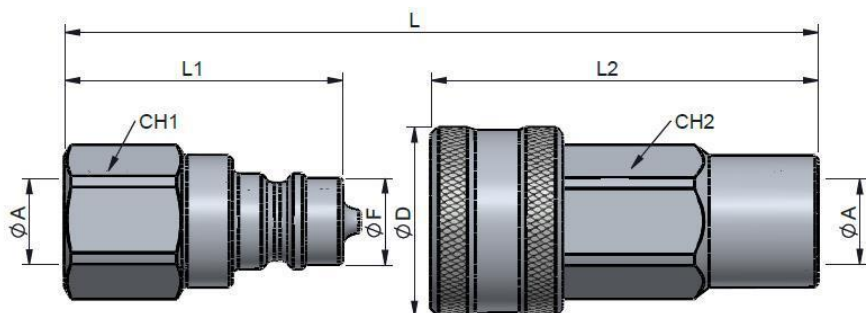

STANDARD MALE MODELS

(S)	ØA	REF.		CH1	L1	ØF	L
6	1/4" BSP	101.21121AB		19	38	12	76
	1/4" NPTF	101.21121BB					

STANDARD FEMALE MODELS

(S)	ØA	REF.		CH2	L2	ØD	L
6	1/4" BSP	101.22121AB		19	53	26	76
	1/4" NPTF	101.22121BB					

(S) 10 - 3/8"

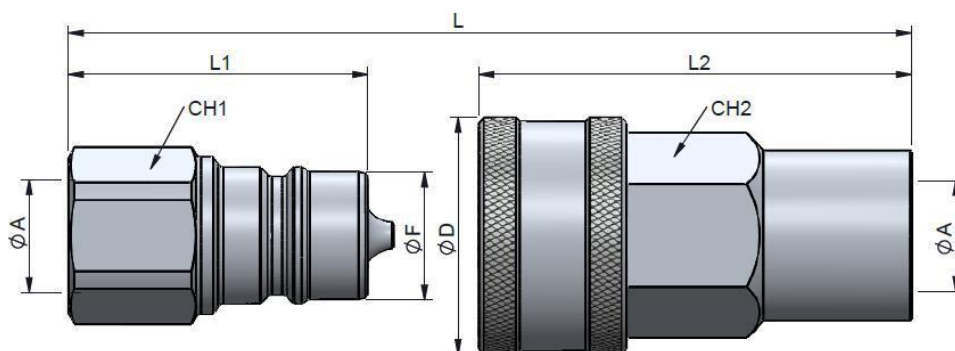

STANDARD MALE MODELS

(S)	ØA	REF.		CH1	L1	ØF	L
10	3/8" BSP	101.21122AC		22	40.5	17	81
	3/8" NPTF	101.21122BC					
	3/8" BSPT	101.21122DC					
	9/16"-18h UNF (ORB)	101.21122GC					

STANDARD FEMALE MODELS

(S)	ØA	REF.		CH2	L2	ØD	L
10	3/8" BSP	101.22122AC		24	58.50	32	81
	3/8" NPTF	101.22122BC					
	3/8" BSPT	101.22122DC					
	9/16"-18h UNF (ORB)	101.22122GC					

L= Total length when Male and Female are connected.

101-8

INTEVA reserves the right to make modifications to its products without prior notice. Any external or internal alterations to our products will automatically void the warranty.



v9





# 101 SERIES

## ISO-A STAINLESS STEEL (AISI 316)

(S) 13 - 1/2"

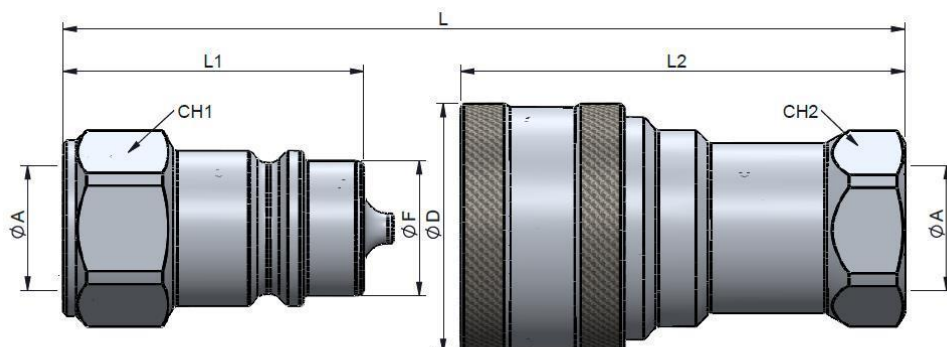

S

(S)	ØA	REF.		CH1	L1	ØF	L
13	1/2" BSP	101.21123AD	260	27/30	46	20.50	87.50
	1/2" NPTF	101.21123BD					
	M22X1.5	101.21123NG		27/30			
	3/4"-16h UNF (ORB)	101.21123GF		27/30			
	7/8"-14h UNF (ORB)	101.21123GH		27/30			

(S)	ØA	REF.		CH2	L2	ØD	L
13	1/2" BSP	101.22123AD	260	30	63.50	38	87.50
	1/2" NPTF	101.22123BD					
	M22X1.5	101.22123NG					
	3/4"-16h UNF (ORB)	101.22123GF					
	7/8"-14h UNF (ORB)	101.22123GH					

(S) 20 - 3/4"

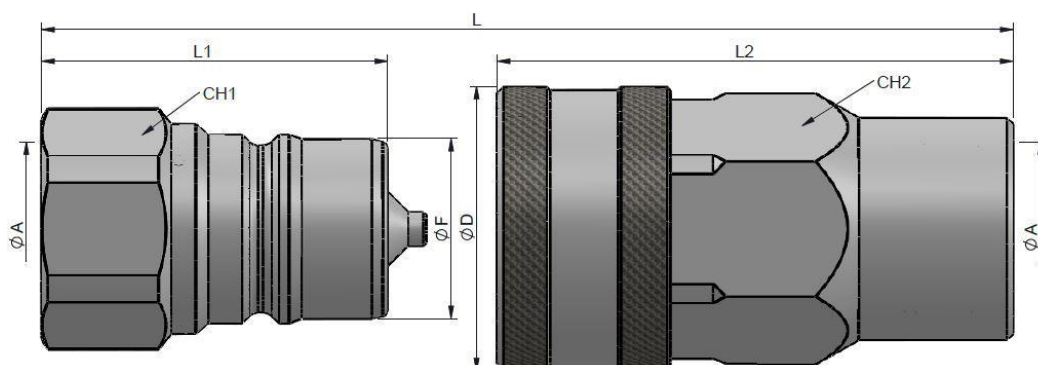

STANDARD MALE MODELS

(S)	ØA	REF.		CH1	L1	ØF	L
20	3/4" BSP	101.21124AE	210	36	56	29	112
	3/4" NPTF	101.21124BE					
	1 1/16"- 12h UN (ORB)	101.21124GK					

STANDARD FEMALE MODELS

(S)	ØA	REF.		CH2	L2	ØD	L
20	3/4" BSP	101.22124AE	210	38	83.5	46	112
	3/4" NPTF	101.22124BE					
	1 1/16"- 12h UN (ORB)	101.22124GK					

L= Total length when Male and Female are connected.



# 101 SERIES

## ISO-A STAINLESS STEEL (AISI 316)

(S) 25 - 1"

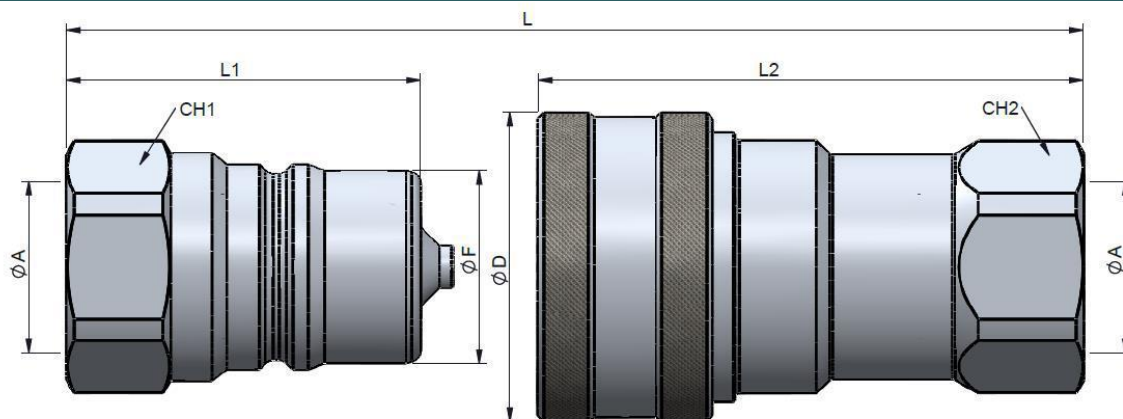

STANDARD MALE MODELS

(S)	ØA	REF.		CH1	L1	ØF	L
25	1" BSP	101.21125AF		41	63	34	126
	1" NPTF	101.21125BF					
	1 5/16"-12h UN (ORB)	101.21125GO					

STANDARD FEMALE MODELS

(S)	ØA	REF.		CH2	L2	ØD	L
25	1" BSP	101.22125AF		46	97	55	126
	1" NPTF	101.22125BF					
	1 5/16"-12h UN (ORB)	101.22125GO					

(S) 32 - 1 1/4"

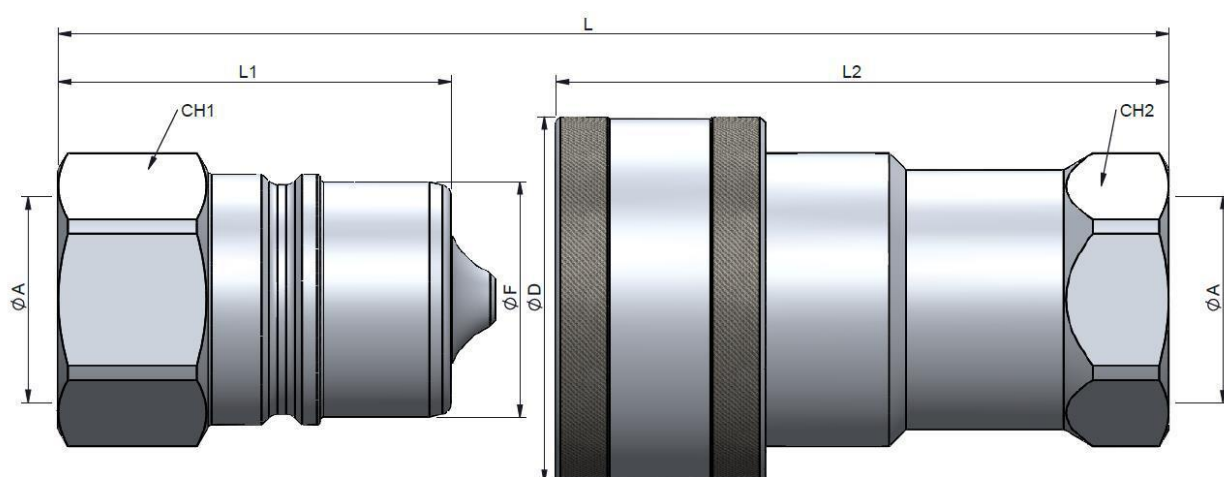

STANDARD MALE MODELS

(S)	ØA	REF.		CH1	L1	ØF	L
32	1 1/4" BSP	101.21126AG		50	75	45	150
	1 1/4" NPTF	101.21126BG					

STANDARD FEMALE MODELS

(S)	ØA	REF.		CH2	L2	ØD	L
32	1 1/4" BSP	101.22126AG		50	117	70	150
	1 1/4" NPTF	101.22126BG					

L= Total length when Male and Female are connected.

101-10

INTEVA reserves the right to make modifications to its products without prior notice. Any external or internal alterations to our products will automatically void the warranty.



v9



# 101 SERIES

## ISO-A STAINLESS STEEL (AISI 316)

(S) 40 - 1 1/2"

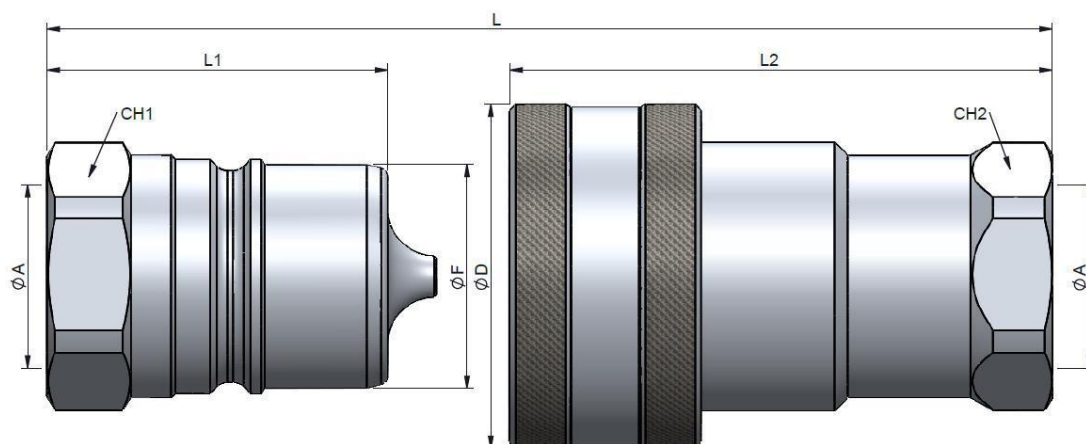

STANDARD MALE MODELS

(S)	ØA	REF.		CH1	L1	ØF	L
40	1 1/2" BSP	101.21127AH		60	83	55	167
	1 1/2" NPTF	101.21127BH					

STANDARD FEMALE MODELS

(S)	ØA	REF.		CH2	L2	ØD	L
40	1 1/2" BSP	101.22127AH		60	133	84.50	167
	1 1/2" NPTF	101.22127BH					

(S) 50 - 2"

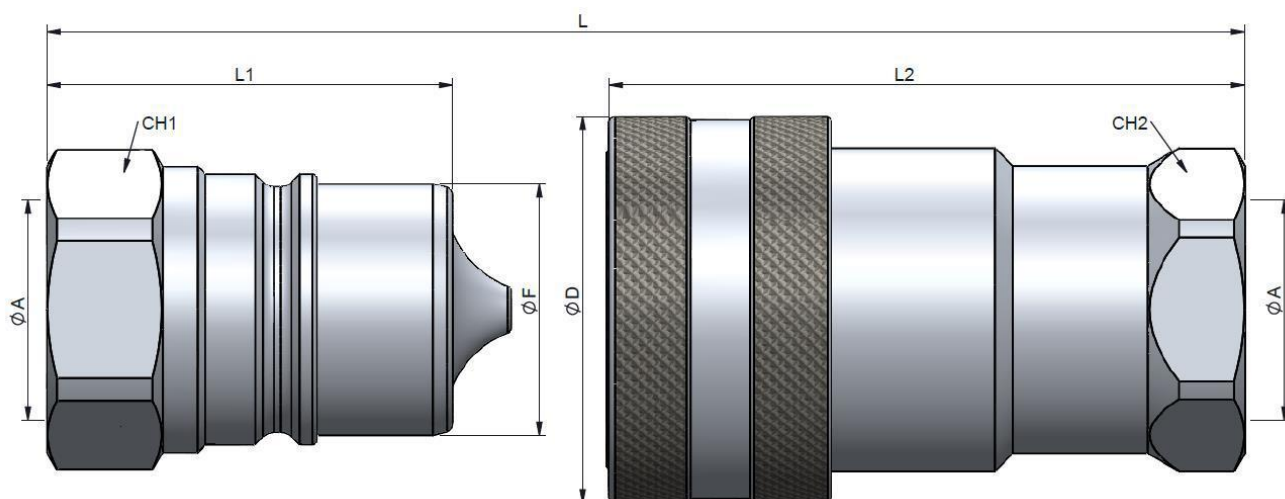

STANDARD MALE MODELS

(S)	ØA	REF.		CH1	L1	ØF	L
50	2" BSP	101.21128AI		75	105	65	210
	2" NPTF	101.21128BI					

STANDARD FEMALE MODELS

(S)	ØA	REF.		CH2	L2	ØD	L
50	2" BSP	101.22128AI		75	165	100	210
	2" NPTF	101.22128BI					

L= Total length when Male and Female are connected.

101-11

INTEVA reserves the right to make modifications to its products without prior notice. Any external or internal alterations to our products will automatically void the warranty.



v9



# 101 SERIES

## ISO-A

STAINLESS STEEL  
(AISI 316)

### TECHNICAL DATA

(S)	Rated Flow	Min Burst Pressure (Bar)			Operating pressure
		Male	Female	Coupled	
6	15 l/min	1150	1200	1250	280
10	35 l/min	16.30	1075	1200	260
13	45 l/min	1050	1150	1200	260
20	74 l/min	855	875	900	210
25	100 l/min	850	875	900	210
32	118 l/min	500	500	650	140
40	410 l/min	480	500	600	120
50	860 l/min	405	415	550	100

Test performed according to ISO 18869

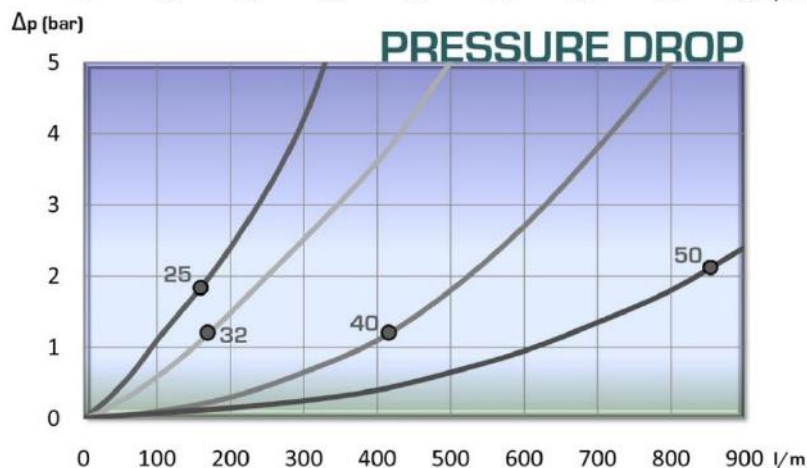
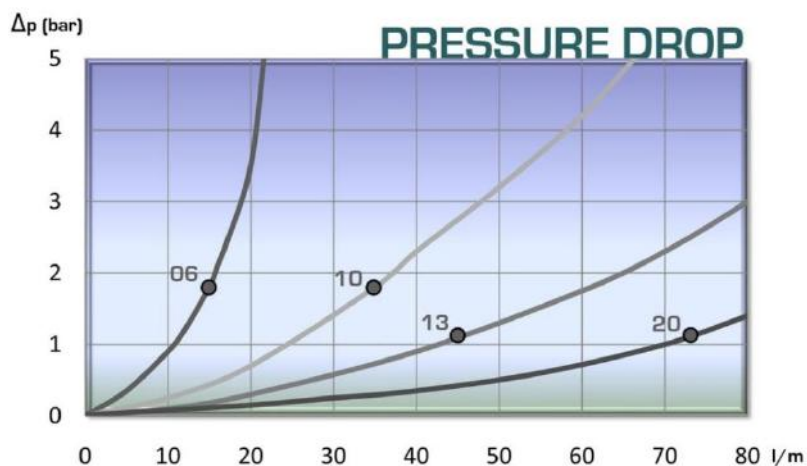





# 101 SERIES ISO-A

PLUGS  
& CAPS

INTEVA

Designed to protect Female (coupler) and Male (nipple) parts while they are disconnected.  
Manufactured according to ISO 7241-A norm (Size 13 - ISO 5675)

## MODEL STRUCTURE / DIMENSIONS

Example:

**101.5333 AA**

Series	Material	Part	Colour	Size (S)	Type
101.	1 Carbon St.	3 Plug	0 Plain Metal	1 6	AA
	5 Plastic	4 Cap	1 Red	2 10	
	6 Aluminium	5 Parking	2 Blue	3 13	
			3 Yellow	4 20	
			4 Green	5 25	
			5 Black		
			6 White		



### PLUG (Coupler)

(S)	RED	BLUE	YELLOW	GREEN	BLACK	WHITE
6	101.5311AA	*	*	*	*	*
10	101.5312AA	*	*	*	*	*
13	101.5313AA	*	*	*	*	*
20	101.5314AA	*	*	*	*	*
25	101.5315AA	*	*	*	*	*

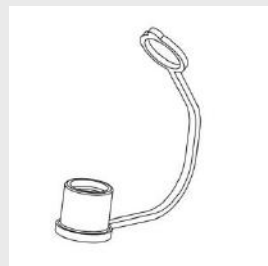

### CAP (Nipple)

(S)	RED	BLUE	YELLOW	GREEN	BLACK	WHITE
6	101.5411AA	*	*	*	*	*
10	101.5412AA	*	*	*	*	*
13	101.5413AA	*	*	*	*	*
20	101.5414AA	*	*	*	*	*
25	101.5415AA	*	*	*	*	*

\* Not available. Only (S) 13 - 1/2" on minimum request.

101-13

INTEVA reserves the right to make modifications to its products without prior notice. Any external or internal alterations to our products will automatically void the warranty.



v9





# 101 SERIES

## ISO-A

CAPS & PLUGS  
ALUMINIUM

Designed to protect Female (coupler) and Male (nipple) parts while they are disconnected.  
Manufactured according to ISO 7241-A norm.

### MODEL STRUCTURE / DIMENSIONS

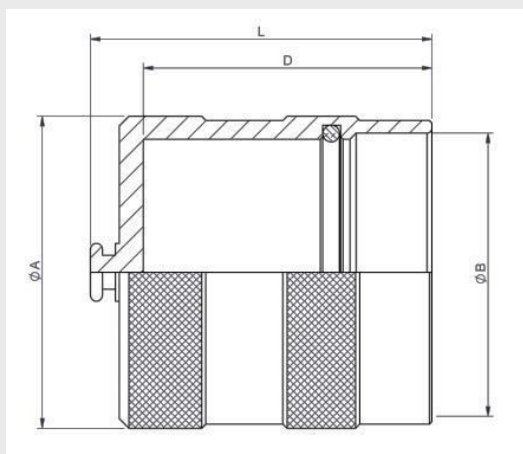

**CAP**

(S)	ØA	REF.	ØB	L	D
32	59	101.6406AA	48	66	55
40	64.8	101.6407AA	57.8	71	60
50	80	101.6408AA	70.2	80	75

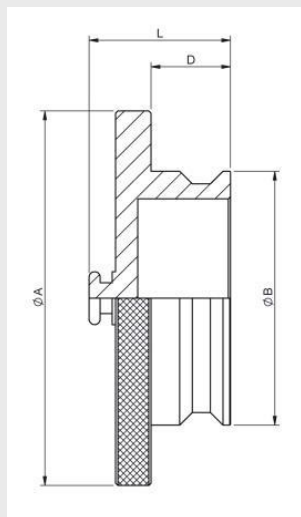

**PLUG (Coupler)**

(S)	ØA	REF.	ØB	L	D
32	69.5	101.6306AA	47.7	30	16
40	84.8	101.6307AA	57.5	32	18
50	100	101.6308AA	69.8	33	25



# 101 SERIES

## ISO-A

PARKINGS  
CARBON STEEL

### MODEL STRUCTURE / DIMENSIONS

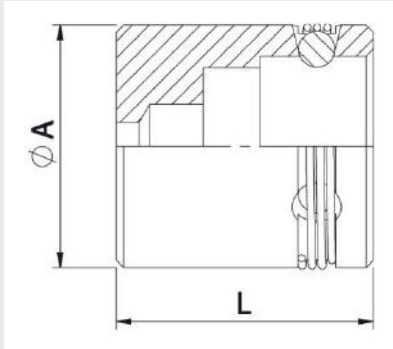

**Parking 3B**

(S)	REF.	ØA	L
13	101.1533AA	32	34

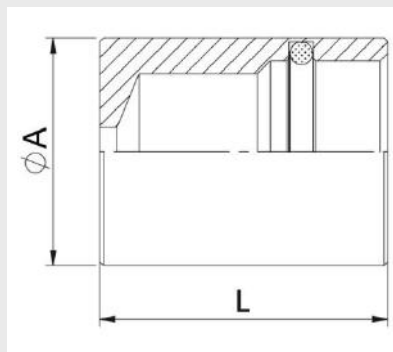

**Parking 1T**

(S)	REF.	ØA	L
13	101.1533AC	30	38

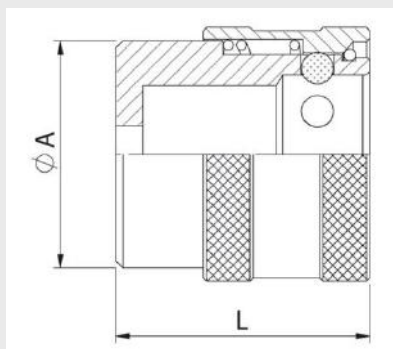

**Parking 6B**

(S)	REF.	ØA	L
13	101.1533AB	34	38



# 102 SERIES

## ISO-A MULTI-THREADS

Manufactured according to ISO 7241-A  
(Size 13 - 1/2" according to ISO 5675 requirements)

### TECHNICAL FEATURES

<b>Operating pressure:</b>	Up to 350 Bar	
<b>Materials:</b>	Body:	Carbon Steel EN -10277-3
	O-rings:	NBR / VITON / EPDM
	Back-up-ring:	PTFE
	Springs:	EN 10270-1/SH
	Balls:	AISI 1010/1015
<b>Available Threads:</b>	BSP / NPTF / ISO 11926 (J1926) ISO 9974 (DIN 3852) / DIN 2353 (ISO 8434-1)	
<b>Closing System:</b>	Poppet Valve or Ball / C.U.R.P.*	
<b>Connection / Disconnection</b>	Sleeve Retraction	
<b>Connection Under Pressure:</b>	Not Allowed	

**Available Size:** 1/4" a 1"

#### Working Temperature (O-rings)

NBR	Viton	EPDM
+100°C	+200°C	+150°C
-30°C	-10°C	-40°C

#### Sectors: Industrial / Agricultural



**Applications:** Designed for Hydraulic Oil (Group II-2014/68/EU)

**Interchange:** FASTER ANV - AEROQUIP FD56  
PARKER 6600 - SNAP-TITE 61

*\*Other upon request.*

### MODEL STRUCTURE

Example:

**102.11112 JE**

Series	Material	Part	Closing	O-rings	Size (S)	Thread
102.	1 Carbon St.	1 Male 2 Female	0 Without 1 Poppet 2 Ball 3 C.U.R.P.*	0 Without 1 NBR 2 VITON 3 EPDM	1 6 2 10 3 13 4 20 5 25	1/4" 3/8" 1/2" 3/4" 1"
						2 letters (see Table of Threads page 999-1)

\* (S) 13 - 1/2" available only.

**102-1**

INTEVA reserves the right to make modifications to its products without prior notice. Any external or internal alterations to our products will automatically void the warranty.



v9



# 102 SERIES ISO-A

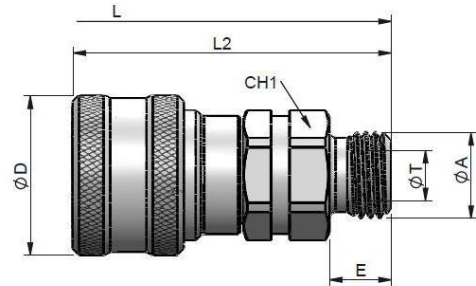
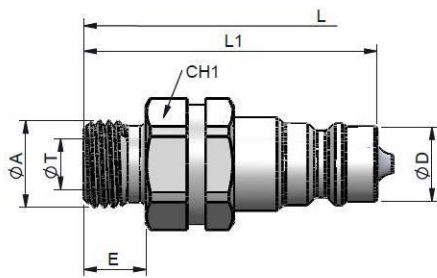

MULTI-THREADS  
THREAD MALE 24° CONE  
DIN 2353 (ISO 8434-1)

(S) 06 - 1/4"



STANDARD MALE MODELS

STANDARD FEMALE MODELS



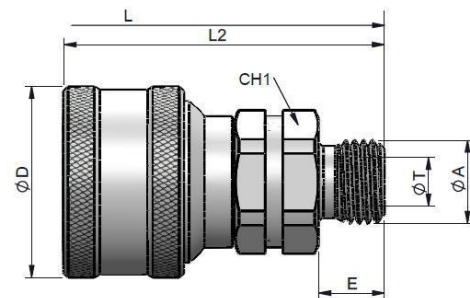
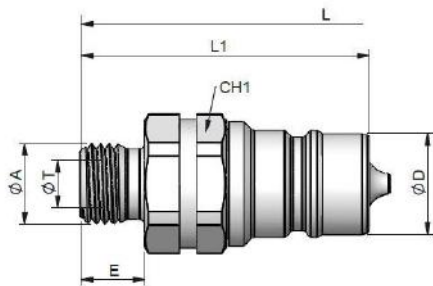

(S)	ØA	ØT		L	REF.		CH1	L1	ØD	E	REF.		CH1	L2	ØD	E
6	M12x1.5	LIGERA	6L	-	102.11111JB	350	19	*	26	12	102.12111JB	350	19	*	26	12
	M14x1.5		8L		102.11111JC						102.12111JC					

(S) 10 - 3/8"



STANDARD MALE MODELS

STANDARD FEMALE MODELS

(S)	ØA	ØT		L	REF.		CH1	L1	ØD	E	REF.		CH1	L2	ØD	E		
10	3/8" BSP	LIGERA	*	-	102.11112AN		300	22	*	17.25	12	102.12112AN		300	22	*	32	12
	M14x1.5		8L		102.11112JC							102.12112JC						
	M16x1.5		10L		102.11112JD							102.12112JD						
	M18x1.5		12L		102.11112JE							102.12112JE						
	M16x1.5	PESADA	8S	102.11112KD	102.12112KD													
	M18x1.5		10S	102.11112KE	102.12112KE													
	M20x1.5		12S	102.11112KF	102.12112KF													



# 102 SERIES ISO-A

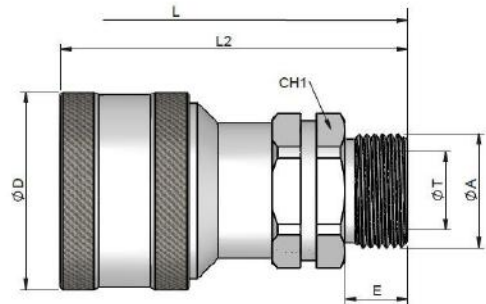
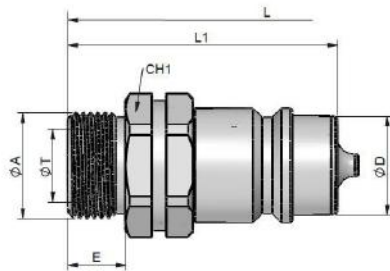

MULTI-THREADS  
THREAD MALE 24° CONE  
DIN 2353 (ISO 8434-1)

(S) 13 - 1/2"



STANDARD MALE MODELS

STANDARD FEMALE MODELS

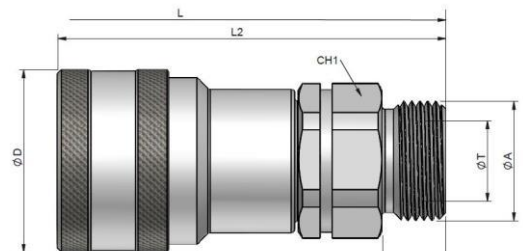
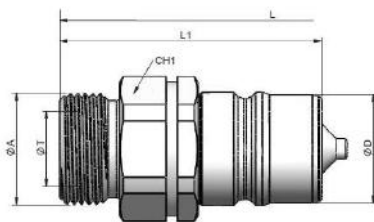

(S)	ØA	ØT		L	REF.		CH1	L1	ØD	E	REF.		CH1	L2	ØD	E	
13	M14x1.5	LIGERA	8L	-	102.11113JC		300	27	*	20.56	12	102.12113JC	300	27	*	38	12
	M16x1.5		10L		102.11113JD							102.12113JD					
	M18x1.5		12L		102.11113JE							102.12113JE					
	M22x1.5		15L		102.11113JG							102.12113JG					
	M26x1.5		18L		102.11113JI							102.12113JI					
	M18x1.5	PESADA	10S		102.11113KE							102.12113KE					
	M20x1.5		12S		102.11113KF							102.12113KF					
	M22x1.5		14S		102.11113KG							102.12113KG					
	M24x1.5		16S		102.11113KH							102.12113KH					

(S) 20 - 3/4"



STANDARD MALE MODELS

STANDARD FEMALE MODELS

(S)	ØA	ØT		L	REF.		CH1	L1	ØD	E	REF.		CH1	L2	ØD	E
20	M18x1.5	LIGERA	12L	-	102.11114JE	250	36	*	29	12	102.12114JE	250	36	*	46	12
	M22x1.5		15L		102.11114JG						102.12114JG					
	M26x1.5		18L		102.11114JI						102.12114JI					
	M30x2.0		22L		102.11114JJ						102.12114JJ					
	M24x1.5	PESADA	16S		102.11114KH					12	102.12114KH					12
	M30x2.0		20S		102.11114KJ					16	102.12114KJ					16

102-3

INTEVA reserves the right to make modifications to its products without prior notice. Any external or internal alterations to our products will automatically void the warranty.



v9





# 102 SERIES ISO-A

MULTI-THREADS  
THREAD MALE 24° CONE  
DIN 2353 (ISO 8434-1)

(S) 25 - 1"

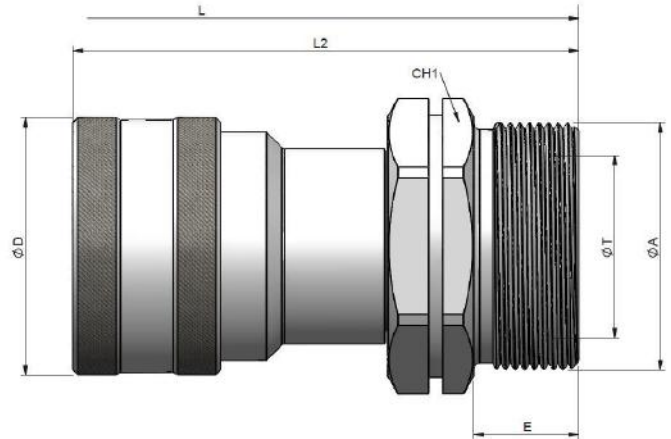
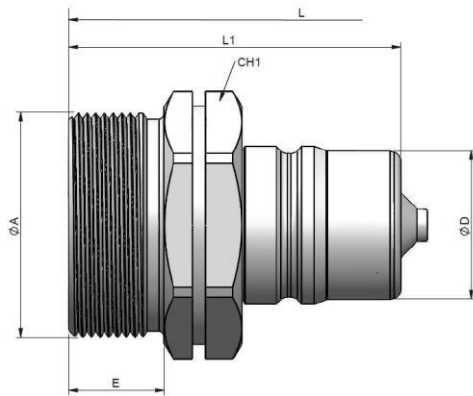

STANDARD MALE MODELS

STANDARD FEMALE MODELS

(S)	ØA	ØT		L	REF.		CH1	L1	ØD	E	REF.		CH1	L2	ØD	E
20	M26x1.5	LIGERA	18L	-	102.11115JI	230	41	*	34.3	12	102.12115JI	230	41	*	55	12
	M30x2		22L		102.11115JJ					18	102.12115JJ					18
	M36x2		28L		102.11115JK						102.12115JK					
	M45x2		35L		102.11115JM					102.12115JM	16					
	M30x2	PESADA	20S		102.11115KJ		18			102.12115KJ	230	41	*	55	18	
	M36x2		25S		102.11115KK					102.12115KK						
	M42x2		30S		102.11115KL					102.12115KL						46
	M52x2		38S		102.11115KN					55					20	102.12115KN



# 102 SERIES ISO-A

MULTI-THREADS  
THREAD MALE BULKHEAD 24° CONE  
DIN 2353 (ISO 8434-1)

(S) 06 - 1/4"

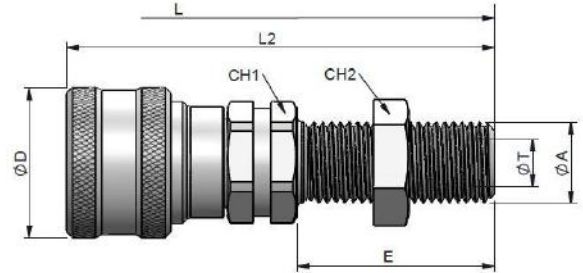
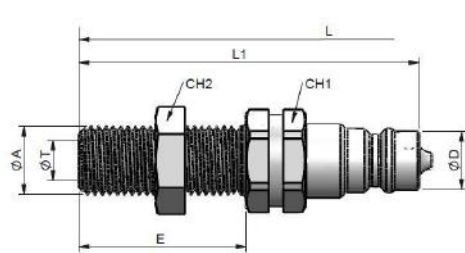

STANDARD MALE MODELS

(S)	ØA	ØT	L	REF.		CH1	CH2	L1	ØD	E	REF.		CH1	CH2	L2	ØD	E
6	M12x1.5	LIGERA	6L	102.11111LB	350	19	19	*	11.8	25	102.12111LB	350	19	19	*	11.8	25
	M14x1.5	LIGERA	8L	102.11111LC						34	102.12111LC						34

STANDARD FEMALE MODELS

(S) 10 - 3/8"

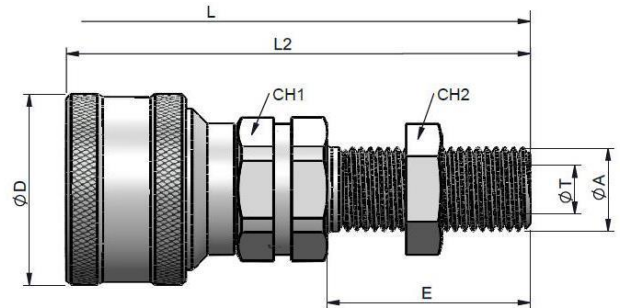
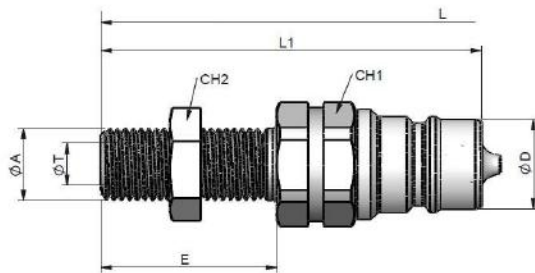

STANDARD MALE MODELS

(S)	ØA	ØT	L	REF.		CH1	CH2	L1	ØD	E	REF.		CH1	CH2	L2	ØD	E
10	M14x1.5	LIGERA	8L	102.11112LC	300	22	22	*	17.25	34	102.12112LC	300	22	22	*	17.25	34
	M16x1.5	LIGERA	10L	102.11112LD						26	102.12112LD						26
	M18x1.5	LIGERA	12L	102.11112LE						27	102.12112LE						27
	M16x1.5	PESADA	8S	102.11112MD						27	102.12112MD						27
	M18x1.5	PESADA	10S	102.11112ME			24				102.12112ME			24			
	M20x1.5	PESADA	12S	102.11112MF			22				102.12112MF			22			

STANDARD FEMALE MODELS

102-5

INTEVA reserves the right to make modifications to its products without prior notice. Any external or internal alterations to our products will automatically void the warranty.



v9



# 102 SERIES ISO-A

MULTI-THREADS  
THREAD MALE BULKHEAD 24° CONE  
DIN 2353 (ISO 8434-1)

(S) 13 - 1/2"

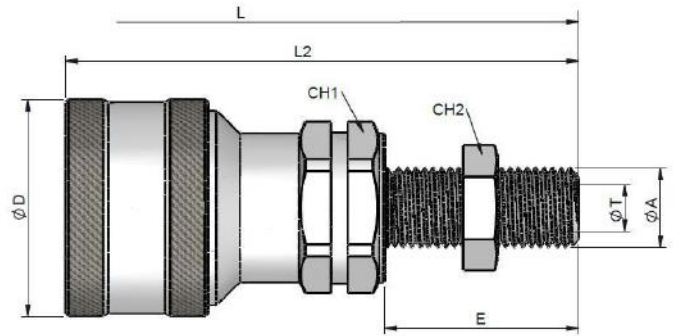
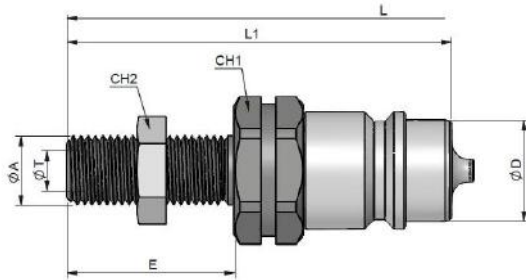

STANDARD MALE MODELS

STANDARD FEMALE MODELS

(S)	ØA	ØT	L	REF.		CH1	CH2	L1	ØD	E	REF.		CH1	CH2	L2	ØD	E
13	M14x1.5	LIGERA	8L	102.11113LC	300	27	19	*	20.56	34	102.12113LC	300	27	19	*	20.56	34
	M16x1.5		10L	102.11113LD			22			35	102.12113LD			22			35
	M18x1.5		12L	102.11113LE			24			24	102.12113LE			24			24
	M22x1.5		15L	102.11113LG			27			33	102.12113LG			27			33
	M26x1.5	PESADA	18L	102.11113LI			30			24	102.12113LI			30			24
	M18x1.5		10S	102.11113ME			24			35	102.12113ME			24			35
	M20x1.5		12S	102.11113MF			22			24	102.12113MF			22			24
	M22x1.5		14S	102.11113MG			27			35	102.12113MG			27			35
	M24x1.5		16S	102.11113MH			30			35	102.12113MH			30			35

(S) 20 - 3/4"

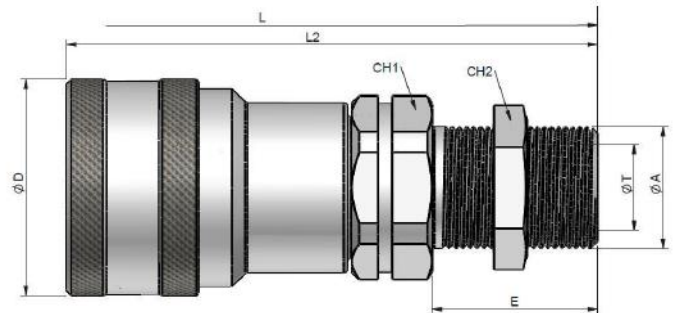
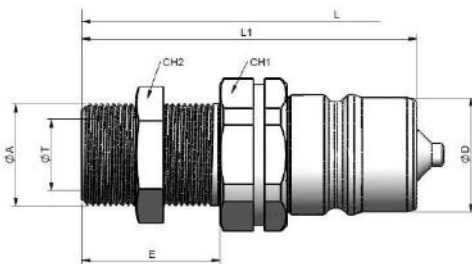

STANDARD MALE MODELS

STANDARD FEMALE MODELS

(S)	ØA	ØT	L	REF.		CH1	CH2	L1	ØD	E	REF.		CH1	CH2	L2	ØD	E
20	M18x1.5	LIGERA	12L	102.11114LE	250	36	24	*	29	26	102.12114LE	250	36	24	*	29	26
	M22x1.5		15L	102.11114LG			27			33	102.12114LG			27			33
	M26x1.5		18L	102.11114LI			30			34	102.12114LI			30			34
	M30x2.0		22L	102.11114LJ			36			29	102.12114LJ			36			29
	M24x1.5	PESADA	16S	102.11114MH			30			36	102.12114MH			30			36
	M30x2.0		20S	102.11114MJ			36			36	102.12114MJ			36			36

102-6

INTEVA reserves the right to make modifications to its products without prior notice. Any external or internal alterations to our products will automatically void the warranty.



v9



# 102 SERIES ISO-A

MULTI-THREADS  
THREAD MALE BULKHEAD 24° CONE  
DIN 2353 (ISO 8434-1)

(S) 25 - 1"

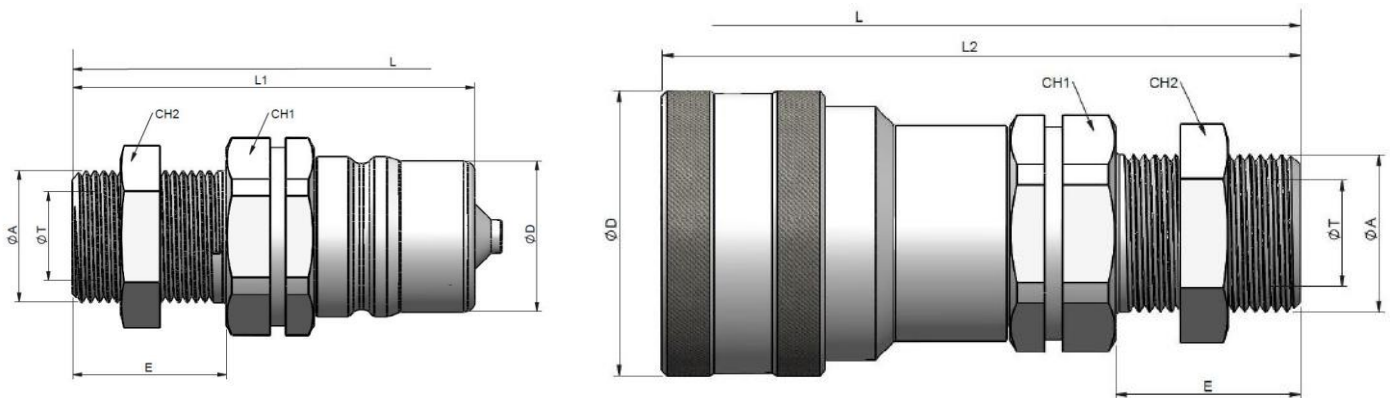

STANDARD MALE MODELS

STANDARD FEMALE MODELS

(S)	ØA	ØT	L	REF.		CH1	CH2	L1	ØD	E	REF.		CH1	CH2	L2	ØD	E
25	M30x2	22L	-	102.11115LJ		41	36	*	34.3	34	102.12115LJ	230	41	36	*	34.3	34
	M36x2	28L		102.11115LK			41			38	102.12115LK			41			38
	M45x2	35L		102.11115LM			55			36	102.12115LM			55			36
	M30x2	20S		102.11115MJ			36			35	102.12115MJ			36			35
	M36x2	25S		102.11115MK			41			38	102.12115MK			41			38
	M42x2	30S		102.11115ML			50			40	102.12115ML			50			40
	M52x2	38S		102.11115MN			65				102.12115MN			65			



# 102 SERIES ISO-A

MULTI-THREADS - FETHREAD MALE  
BSP / NPTF / ISO 11926 (J1926)  
ISO 9974 (DIN 3852)

(S) 06 - 1/4"

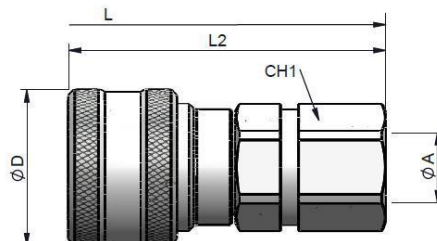
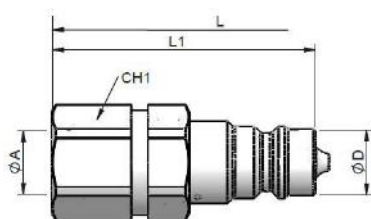

STANDARD MALE MODELS

(S)	ØA	L	REF.		CH1	L1	ØD
6	1/4" BSP	-	102.11111AB		19	*	11.8
	1/4" NPTF		102.11111BB				
	M14x1.5		102.11111NC				

STANDARD FEMALE MODELS

REF.		CH1	L2	ØD
102.12111AB		19	*	26
102.12111BB				
102.12111NC				

(S) 10 - 3/8"

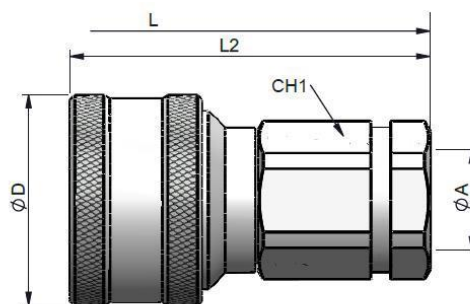
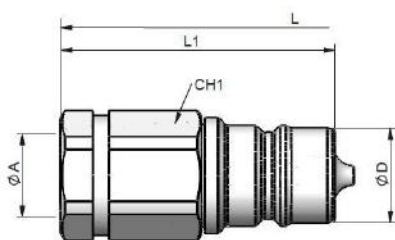

STANDARD MALE MODELS

(S)	ØA	L	REF.		CH1	L1	ØD
10	1/4" BSP	-	102.11112AB		22	-	17.25
	3/8" BSP		102.11112AC				
	3/8" NPTF		102.11112BC				
	M16x1.5		102.11112ND				

STANDARD FEMALE MODELS

REF.		CH1	L2	ØD
102.12112AB		22	*	32
102.12112AC				
102.12112BC				
102.12112ND				

102-8

INTEVA reserves the right to make modifications to its products without prior notice. Any external or internal alterations to our products will automatically void the warranty.



v9





# 102 SERIES ISO-A

MULTI-THREADS - FETHREAD MALE  
BSP / NPTF / ISO 11926 (J1926)  
ISO 9974 (DIN 3852)

(S) 13 - 1/2"

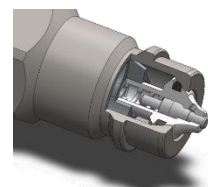
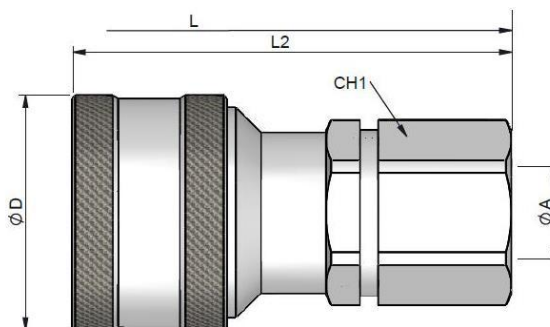
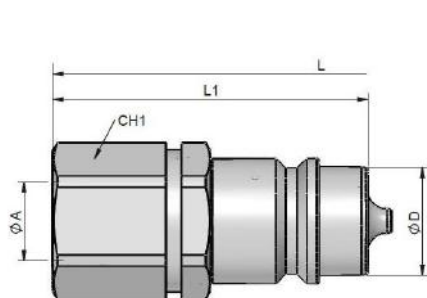

C.U.R.P. System available  
Allowed connection under  
residual pressure.

STANDARD MALE MODELS

STANDARD FEMALE MODELS

(S)	ØA	L	REF.	CH1	L1	ØD	REF.	CH1	L2	ØD
13	3/8" BSP	-	102.11113AC	300	27	20.56	102.12113AC	300	27	38
	1/2" BSP		102.11113AD				102.12113AD			
	1/2" NPTF		102.11113BD				102.12113BD			
	M18x1.5		102.11113NE				102.12113NE			
	M22x1.5		102.11113NG				102.12113NG			
	3/4"-16h UNF (ORB)		102.11113GF				102.12113GF			
	7/8"-14h UNF (ORB)		102.11113GH				102.12113GH			

(S) 20 - 3/4"

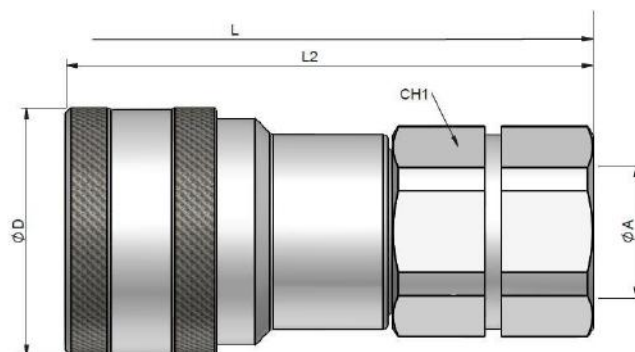
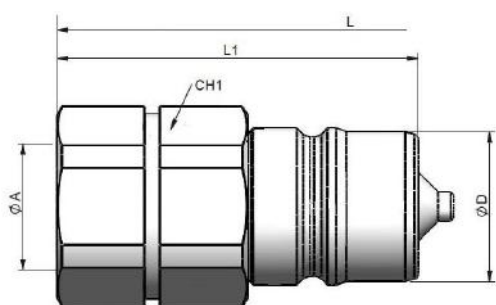

STANDARD MALE MODELS

STANDARD FEMALE MODELS

(S)	ØA	L	REF.	CH1	L1	ØD	REF.	CH1	L2	ØD
20	3/4" BSP	-	102.11114AE	230	36	29	102.12114AE	230	26	46
	3/4" NPTF		102.11114BE				102.12114BE			
	M22x1.5		102.11114NG				102.12114NG			

102-9

INTEVA reserves the right to make modifications to its products without prior notice. Any external or internal alterations to our products will automatically void the warranty.



v9



# 102 SERIES ISO-A

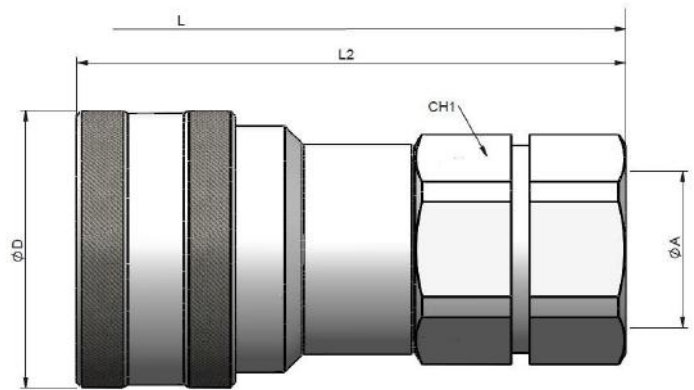
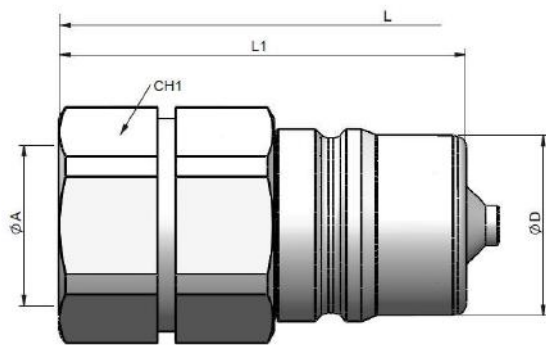

MULTI-THREADS - FETHREAD MALE  
BSP / NPTF / ISO 11926 (J1926)  
ISO 9974 (DIN 3852)

(S) 25 - 1"



STANDARD MALE MODELS

STANDARD FEMALE MODELS

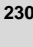
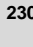
(S)	ØA	L	REF.		CH1	L1	ØD	REF.		CH1	L2	ØD
25	3/4" BSP	-	102.11115AE		36	*	34.3	102.11115AE		41	*	55
	1" BSP		102.11115AF					102.11115AF				
	1" NPTF		102.11115BF					102.11115BF				

102-10

INTEVA reserves the right to make modifications to its products without prior notice. Any external or internal alterations to our products will automatically void the warranty.



v9